

Inch Series Low Head Socket Cap Screws

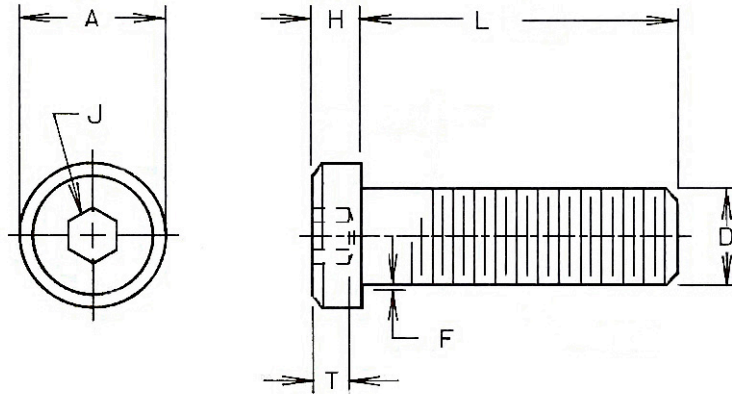

Nominal Size	Basic Screw Diameter	A Head Diameter		H Head Height		J Hex Socket Size		T Key Engagement	F Fillet Extension	
		Max.	Min.	Max.	Min.	Nominal	Min.	Max.	Min.	
#4	0.1120	0.183	0.178	0.056	0.053	0.0500	0.038	0.009	0.005	
#5	0.1250	0.205	0.200	0.062	0.059	1/16 0.062	0.044	0.010	0.006	
#6	0.1380	0.226	0.221	0.069	0.066	1/16 0.062	0.050	0.010	0.006	
#8	0.1640	0.270	0.265	0.082	0.079	5/64 0.078	0.060	0.012	0.007	
#10	0.1900	0.132	0.307	0.095	0.092	3/32 0.094	0.072	0.014	0.009	
1/4	0.2500	0.375	0.369	0.125	0.121	1/8 0.125	0.094	0.014	0.009	
5/16	0.3125	0.437	0.431	0.156	0.152	5/32 0.156	0.120	0.017	0.012	
3/8	0.3750	0.562	0.556	0.187	0.182	3/16 0.188	0.145	0.020	0.015	
7/16	0.4375	0.625	0.618	0.218	0.213	7/32 0.219	0.166	0.023	0.018	
1/2	0.5000	0.750	0.753	0.250	0.244	1/4 0.250	0.184	0.026	0.020	
5/8	0.6250	0.875	0.867	0.312	0.306	5/16 0.312	0.250	0.032	0.024	

Standard Length Increments

Nominal Screw Length

1/8 through 1/4
 Over 1/4 through 1 inch
 Over 1 through 2 inches

Standard Length Increment

1/16
 1/8
 1/4

Length Tolerances

Nominal Screw Size	#4 Through 3/8	1/2 and 5/8
Nominal Screw Length	Tolerance on Length	
Through 1 inch long	-0.03	-0.03
Over 1 through 2 1/2 inches long	-0.04	-0.06

Inch Series Low Head Socket Cap Screws (continued)

Mechanical Properties and Tightening Torques

Nominal Size	Basic Screw Diameter	Tensile Strength Pounds Min.	Shear Strength Pounds Min.	Tightening Torque Inch-Pounds
#4	0.1120	840	620	5.0
#5	0.1250	1100	820	9.5
#6	0.1380	1260	940	9.5
#8	0.1640	1940	1450	19.0
#10	0.1900	2440	1810	30
1/4	0.2500	4430	3300	75
5/16	0.3125	7300	5430	150
3/8	0.3750	10800	8040	275
7/16	0.4375	14800	11000	425
1/2	0.5000	19800	14700	600
5/8	0.6250	31500	23400	1300

